

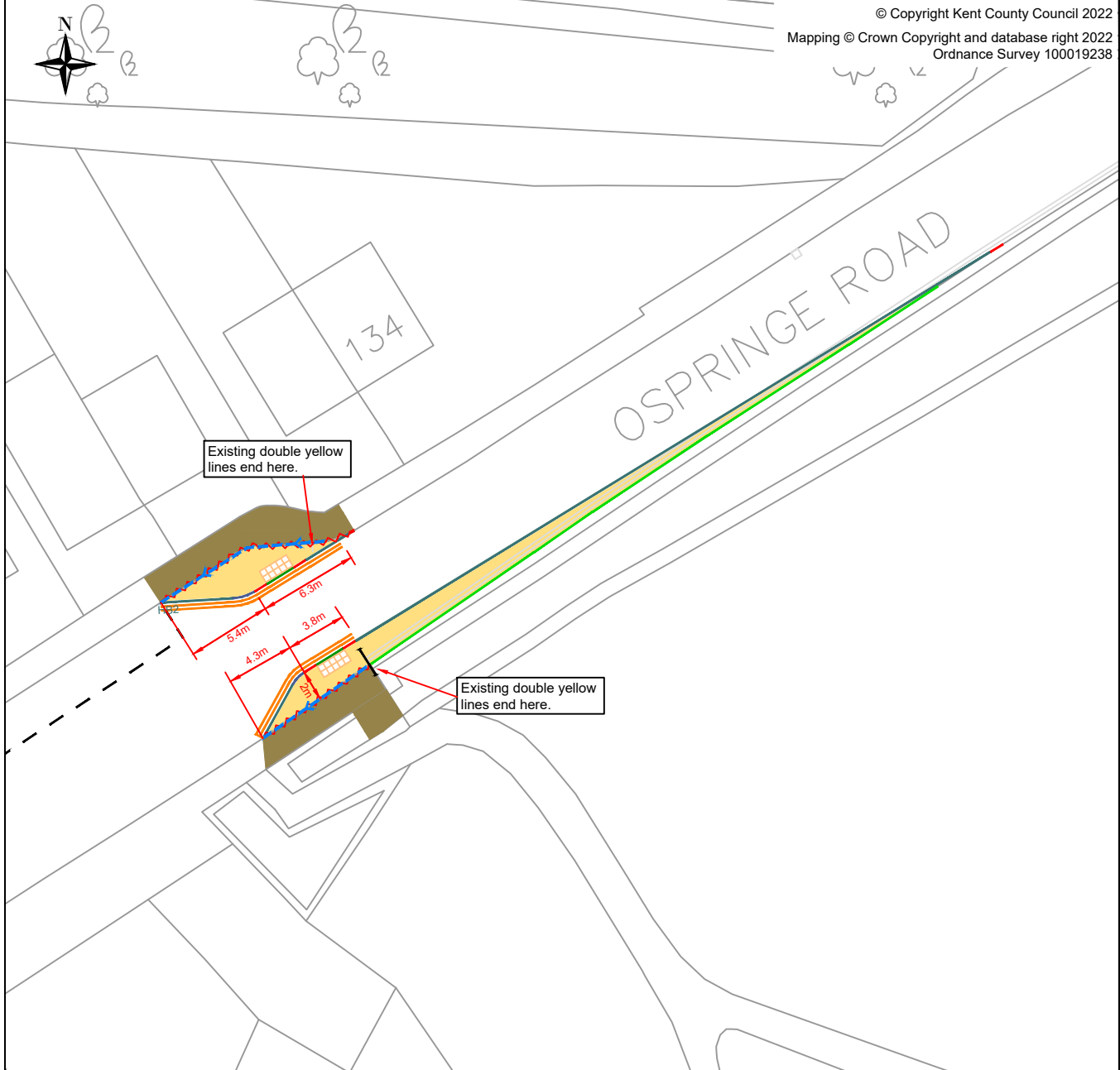

© Copyright Kent County Council 2022
 Mapping © Crown Copyright and database right 2022
 Ordnance Survey 100019238



Notes

0	20/02/23	FOR CONSULTATION	DB	LW	WB
Rev	Revision Date	Purpose of revision	Drawn	Chc'd	App'd



Kent County Council
 Ashford Highway Depot
 Henwood Industrial Estate
 Ashford
 TN24 8AD
 Tel: 03000 418181

Project
**OSPRINGLE ROAD, FAVERSHAM
 PEDESTRIAN CROSSING IMPROVEMENT**

Drawing title
**TRO CONSULTATION
 EXTENTION TO EXISTING
 DOUBLE YELLOW LINES**

Drawing status
FOR CONSTRUCTION

Scale
1:250 at A3 **Do not scale**

Drawing number
22-23-SW-LTP-65-100

Rev
0

This drawing is not to be used in whole or part other than for the intended purpose and project as defined on this drawing. Refer to the contract for full terms and conditions.