

SECTION 278 GENERAL ARRANGEMENT
SCALE 1:200

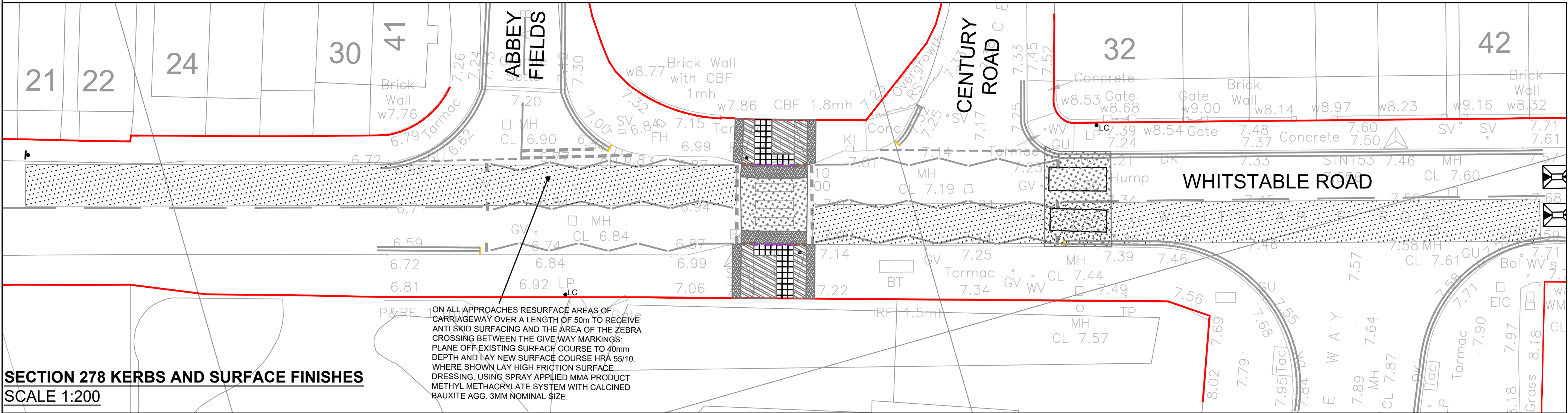

SECTION 278 KERBS AND SURFACE FINISHES
SCALE 1:200

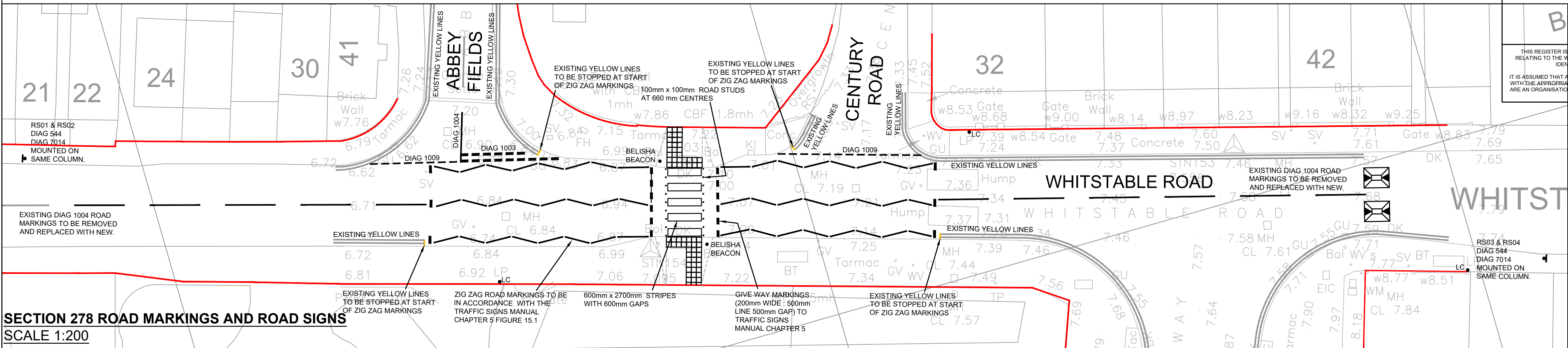

SECTION 278 ROAD MARKINGS AND ROAD SIGNS
SCALE 1:200

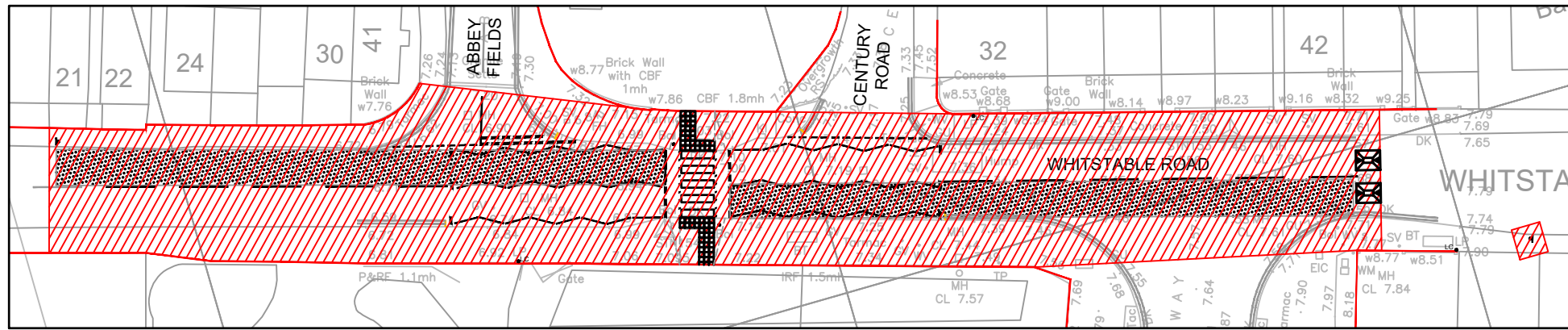

SECTION 278 LEGAL PLAN
SCALE 1:500

ROAD SIGN SCHEDULE				
SIGN REF	ILLUSTRATION	ILLUMINATION	NOTES	
RS01	DIAGRAM 544 MOUNTED ON SAME POST AS RS02.	NO BUT REFLECTORISED	SIGN TO BE 600mm HIGH FOR 30mph ROAD SPEED.	
RS02	DIAGRAM 7014 MOUNTED ON SAME POST AS RS01.	NO BUT REFLECTORISED	SIGN TO BE 600mm HIGH FOR 30mph ROAD SPEED.	
RS03	DIAGRAM 544 MOUNTED ON SAME POST AS RS4.	NO BUT REFLECTORISED	SIGN TO BE 600mm HIGH FOR 30mph ROAD SPEED.	
RS04	DIAGRAM 7014 MOUNTED ON SAME POST AS RS03.	NO BUT REFLECTORISED	SIGN TO BE 600mm HIGH FOR 30mph ROAD SPEED.	

ROAD MARKING SCHEDULE				
DIAG No.	MARK LENGTH (m).	MARK WIDTH (m).	GAP LENGTH (m).	NOTES.
1002.1	VARIABLES	0.3	-	
1003	0.6	0.2	0.3	TWO ROWS AT 500CRS
1004	4.0	0.1	2.0	
1009	0.6	0.1	0.3	
1025.4	1.0	0.1	1.0	TEXT 1.6m HIGH ALL MARKINGS YELLOW.
1026.1	VARIABLES	0.075	-	375mm LONG 75mm WIDE T AT END OF 1026.1 LINE.
1038	2.0	-	-	
1040	4.0	0.1	2.0	100mm WIDE CHEVRON MARKINGS AT 45°
1040.2	4.0	0.1	2.0	100mm WIDE CHEVRON MARKINGS AT 45°

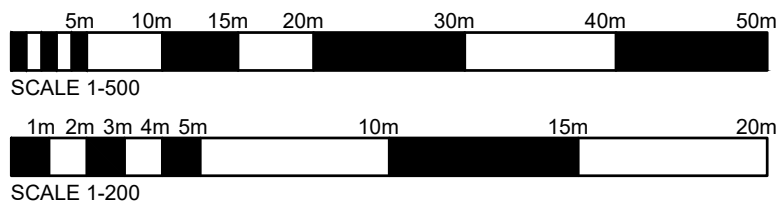

NOTES
CONTRACTORS MUST VERIFY ALL DIMENSIONS ON SITE BEFORE COMMENCING ANY WORK ON SHOP DRAWINGS
DO NOT SCALE FROM THIS DRAWING
RCD CONSULTANTS LTD COPYRIGHT

S278 DRAWING LEGEND

	CARRIAGEWAY RESURFACING CONSTRUCTION
	ASPHALT FOOTPATH CONSTRUCTION
	CARRIAGEWAY/FOOTWAY REINSTATEMENT TIE-IN CONSTRUCTION
	TACTILE PAVING
	HIGH FRICTION SURFACING
	255x125 HB2 HALF BATTERED KERB
	150x125 BN DROPPED KERB
	TRANSITION KERB
	150x50 EF EDGING KERB
	EXISTING HIGHWAY BOUNDARY
	AREA OF S278 WORKS
	ROAD SIGN.
	STREET NAME PLATE.
	EXISTING LIGHTING COLUMN.
	MARSHALL'S REINFORCED CONCRETE SPEED CUSHION

- NOTES
- ALL DIMENSIONS IN MILLIMETERS UNLESS NOTED OTHERWISE.
 - THIS DRAWING TO BE READ IN CONJUNCTION WITH ALL OTHER ENGINEERING DRAWINGS AND CALCULATIONS ASSOCIATED WITH THIS PROJECT.
 - ALL COMPONENTS AND MATERIALS ARE TO BE MANUFACTURED AND SUPPLIED IN ACCORDANCE WITH THE RELEVANT BRITISH STANDARDS, AND LAID AND BACKFILLED IN ACCORDANCE WITH MANUFACTURER'S INSTRUCTIONS AND THE RELEVANT BRITISH STANDARDS.
 - THE CONTRACTOR SHALL, BEFORE COMMENCING THE WORKS, VERIFY ALL SITE AND SETTING OUT DIMENSIONS. THE CONTRACTOR SHALL BE RESPONSIBLE FOR THE TRUE AND PROPER SETTING OUT OF THE WORKS AND FOR THE CORRECTNESS OF THE POSITION, LEVELS, DIMENSIONS, AND ALIGNMENT OF ALL PARTS OF THE WORKS.
 - ALL WORK WITHIN THE HIGHWAY IS TO BE COMPLETED IN ACCORDANCE WITH THE KENT COUNTY COUNCIL HIGHWAYS DEPARTMENT SPECIFICATION AND REQUIREMENTS AND UNDER A SECTION 278 AGREEMENT.
 - ALL ROAD MARKINGS AND ROAD SIGNS ARE TO BE MMA PRODUCT AND CONSTRUCTED IN ACCORDANCE WITH THE TRAFFIC SIGNS REGULATIONS AND GENERAL DIRECTIONS 2016.
 - THE WHOLE EXTENTS OF THE S278 CARRIAGEWAY WILL REQUIRE RESURFACING.

CDM REGULATIONS 2015 RESIDUAL HAZARDS
RESIDUAL HAZARDS IDENTIFIED

CONSTRUCTION

- NO SIGNIFICANT RESIDUAL HAZARDS BEYOND THOSE KNOWN TO AN EXPERIENCED CONTRACTOR.

FUTURE DEMOLITION

- NO SIGNIFICANT RESIDUAL HAZARDS BEYOND THOSE KNOWN TO AN EXPERIENCED CONTRACTOR.

THIS REGISTER IS A NON-EXHAUSTIVE LIST OF RESIDUAL HAZARDS RELATING TO THE WORKS SHOWN ON THIS DRAWING THAT HAVE BEEN IDENTIFIED DURING THE DESIGN STAGE.
IT IS ASSUMED THAT ALL WORKS WILL BE CARRIED OUT BY A CONTRACTOR WITH THE APPROPRIATE SKILLS, KNOWLEDGE & EXPERIENCE, AND IF THEY ARE AN ORGANISATION, THE ORGANISATIONAL CAPABILITY NECESSARY TO FULFILL THE ROLE.

P3	NEW SPEED CUSHIONS ADDED.	14.09.2021	RAC
P2	AMENDED TO SUIT HIGHWAY AND RSA	04.08.2021	RAC
P1	PRELIMINARY ISSUE	09.06.2021	RAC
REV	AMENDMENT	DATE	CHKD

DRAWING STATUS

PRELIMINARY

RCD

RCD CONSULTANTS LTD
9 BIRCH TREE WAY, MAIDSTONE, KENT, ME15 7RP
MOBILE: 07702 052 137
EMAIL: ray@rtd-uk.com

CLIENT
VINSON TRUST

PROJECT
PROPOSED ZEBRA CROSSING
WHITSTABLE ROAD
FAVERSHAM

DRAWING TITLE
SECTION 278 LAYOUTS

CIVILS

SCALE 1:200 @ A1
1:400 @ A3
DRAWN BY LD
CHECKED RAC
DATE JUN 2021

DRAWING NUMBER
1111-2112-CIV-200
REVISION
P3